



**ACCREDITED**  
HOME ELEVATOR COMPANY

# Electric Elevator System



Specification type	Electric
<b>Load Capacity</b>	950 lbs.
<b>Rated Speed</b>	40 Fpm
<b>Power supply</b> <i>(Circuit supplied by others)</i>	230V single phase 30amp
<b>Lighting Supply</b> <i>(Circuit supplied by others)</i>	120V 15 amp
<b>Drive system</b>	2HP geared 3 speed inverter duty motor with 60lb roller chain and variable frequency drive.
<b>Maximum Travel</b>	50 Feet
<b>Control System</b>	Microprocessor based controller with led diagnostics
<b>Levels and openings</b>	Up to 6 stops / up to 2 openings
<b>Pit depth</b>	Minimum 9.00"
<b>Overhead</b>	96" for standard 7'0" cab.
<b>Cab size</b>	Dependent upon host-way size. Not to exceed 15 Square feet.
<b>Standard features</b>	<ul style="list-style-type: none"><li>• Recessed gate pocket.</li><li>• Variable frequency inverter drive for smooth start, stop, &amp; leveling.</li><li>• Motor at top or rails for reduced machine space.</li><li>• Automatic cab lighting.</li><li>• Car here lights at all hall stations.</li><li>• Auto homing feature.</li><li>• Unfinished plywood flooring.</li><li>• Hardwood veneer cab.</li><li>• Accordion Gates.</li></ul>
<b>Safety features</b>	<ul style="list-style-type: none"><li>• Type A instantaneous safeties.</li><li>• Manually reset slack rope switch.</li><li>• Drive overload circuit.</li><li>• Drive overspeed circuit.</li><li>• Positively open gate safety switch.</li><li>• Upper, lower, and final limits.</li><li>• Emergency stop and alarm.</li><li>• Pit and car top stop switches.</li></ul>

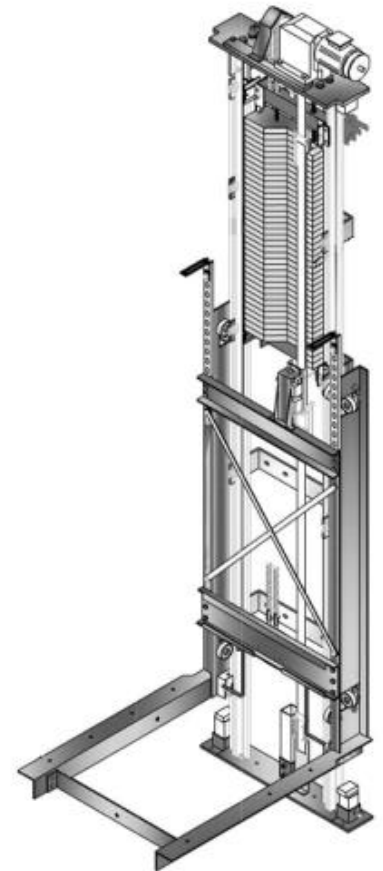

**Accredited Home Elevator Company**

**www.accelelevator.com (800) 488 5905**

**AHE | 127 S Main Street Barnegat, NJ 08005 | marketing@accelelevator.com**